

Sunset Regional Park

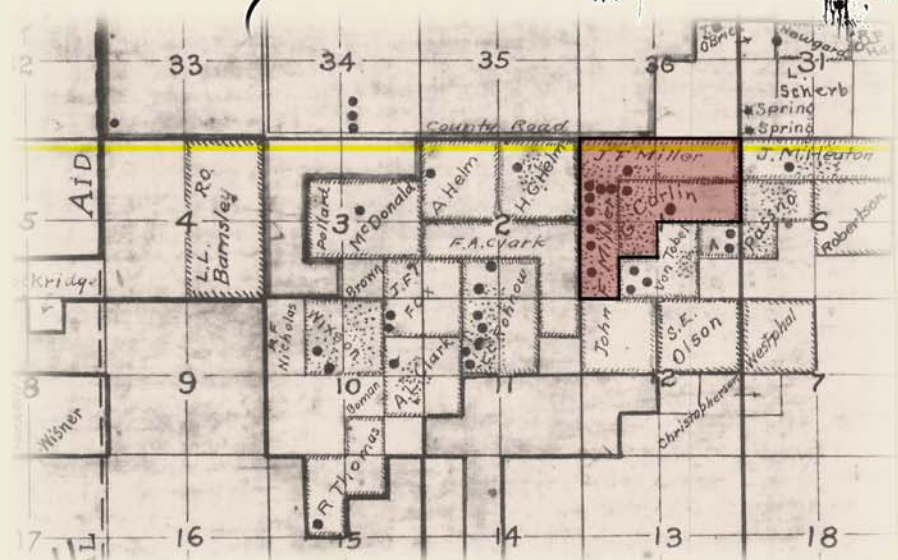

Surveyor John T. McWilliams' 1912 map shows the John F. Miller and George Carlin ranches, which eventually became Sunset Park. Pioneer truck farmer Yonema "Bill" Tomiyasu later bought the A. Passno property. The "County Road" became Sunset Road. The Wixson ranch, shown in the panoramic photo, is two miles west of the Miller Ranch.
 - Clark County Museum

The Physical Setting of Sunset Park

Sunset Park is located in Paradise Valley, which is in the southern portion of Las Vegas Valley in the eastern portion of the Mojave Desert. In this smallest, driest and hottest of North America's four deserts, annual rainfall averages 4.5 inches, and daytime temperatures range from 20°F in winter to well over 100°F in summer. The elevation at Sunset Park is about 1,800 feet, while nearby Mt. Charleston soars to 11,918 feet.



Bert Gibbs hunting in the area of today's Sunset Park around 1932, among the dunes of Paradise Valley.
 - Gibbs Family Collection

More than 200 plant species are found only in the Mojave Desert. Many plants found in the other North American deserts (Great Basin, Sonoran and Chihuahuan) also thrive here, including the creosote bush, prickly pear, cholla cactus, and salt bush.

Mesquite trees flourish in Sunset Park because their root systems tap into the water table. They produce tons of edible beans every year that are eaten by wildlife in the Park and were a major food source for native people.



A Las Vegas woman poses in the dunes of Paradise Valley around 1919.
 - Special Collections, Lied Library, UNLV

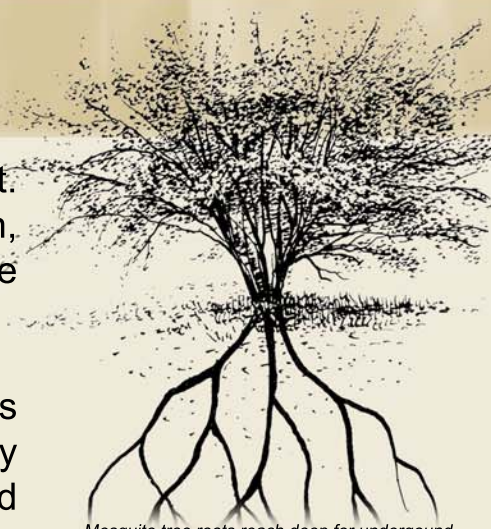

Mesquite tree roots reach deep for underground water.
 - Ann and Myron Sutton, Our Living World of Nature

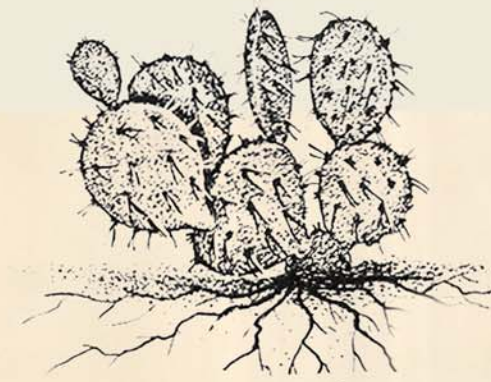

Prickly Pear cactus roots spread out near the ground surface to absorb rainwater.
 - Ann and Myron Sutton, Our Living World of Nature



In late 1910, the Wixson Ranch was two miles WSW of today's Sunset Park. Here you can see an artesian well, stands of corn, a greenhouse, and the Wixson home. Frenchman Mountain is in the left background and Black Mountain rises from behind the greenhouse.
 - Nevada State Museum and Historical Society

Sunset Park Setting

Funding has been provided by the Bureau of Land Management through the sale of public lands as authorized by the Southern Nevada Public Land Management Act.